

Attachment point weldable profilift eta

2131.50.

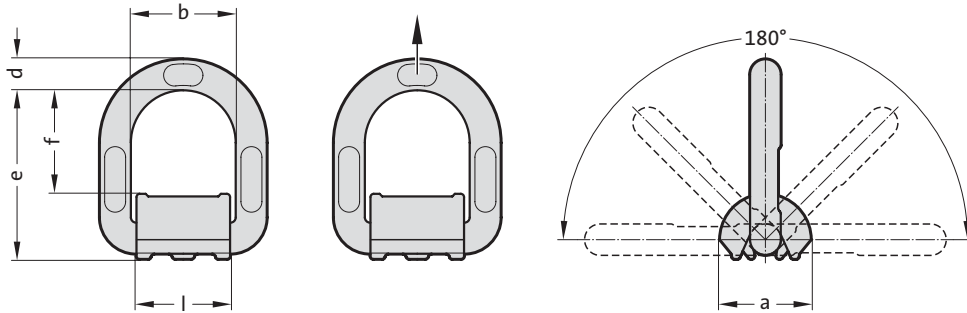

Description:

For welding work, the conditions according to DIN EN ISO 14341 apply. Welding work may only be performed by a welder with qualification according to EN 287-1.

Material:

Weld-on bracket: S355 J2 G3
Ring: high-strength alloyed steel

Note:

Information about installation and removal, see operating instructions. Load capacity according to operating instructions or load capacity table in the specified directions of pull.

When selecting the arrangement, make sure that unequal loading does not occur, e.g. if:

- no free adjustment is possible in the direction of pull
- direction of pull does not lie in the specified range
- when fit closely at edges or surfaces

2131.50. Attachment point weldable profilift eta

Order No	Rated carrying capacity [t]	Size	a	b	d	e	f	l
2131.50.006	1.12	006	36	40	11	67	42	35
2131.50.008	2	008	37	42	13	73	45	37
2131.50.010	3.15	010	41	45	16.5	80	47	40
2131.50.013	5.3	013	61	55	22	97	53	50
2131.50.016	8	016	63	70	25	120	73	64
2131.50.022	15	022	89	97	33	163	92	90

Max. carrying capacity "G" in tonnes for various types of attachment

Type of attachment										
Number of lines	1	1	2	2	2	2	3+4	3+4	2	3+4
Angle of inclination/ load direction	0°	90°	0°	90°	0-45°	45-60°	0-45°	45-60°	asymmetrical	asymmetrical
Order No	carrying capacity in tonnes									
2131.50.006	1.12	1.12	2.24	2.24	1.5	1.12	2.3	1.6	1.12	1.12
2131.50.008	2	2	4	4	2.8	2	4.2	3	2	2
2131.50.010	3.15	3.15	6.3	6.3	4.4	3.15	6.6	4.7	3.15	3.15
2131.50.013	5.3	5.3	10.6	10.6	7.4	5.3	11.2	7.9	5.3	5.3
2131.50.016	8	8	16	16	11.3	8	16.9	12	8	8
2131.50.022	15	15	30	30	21	15	31.8	22.5	15	15